

## Installation Instructions

Holden Colorado (2016+)



Step

Instructions

1

Carefully remove the silver air vent trims.



2

Remove screws, on each side of the air vents.



3

Remove plastic trim and panel on passenger side.



If you have any issues or questions, please contact us.



- 4 Carefully lift out and forward central console.  
You can unplug some wires to make access easier for job completion.



- 5 If air con plugs pop out, refer to below image for repositioning.



- 6 Remove right-side panel, and lower panel around lower control unit.



If you have any issues or questions, please contact us.

- 7 Remove 4 screws and lift out lower control unit.



- 8 Install side brackets (L+R), by using existing screw at the back.

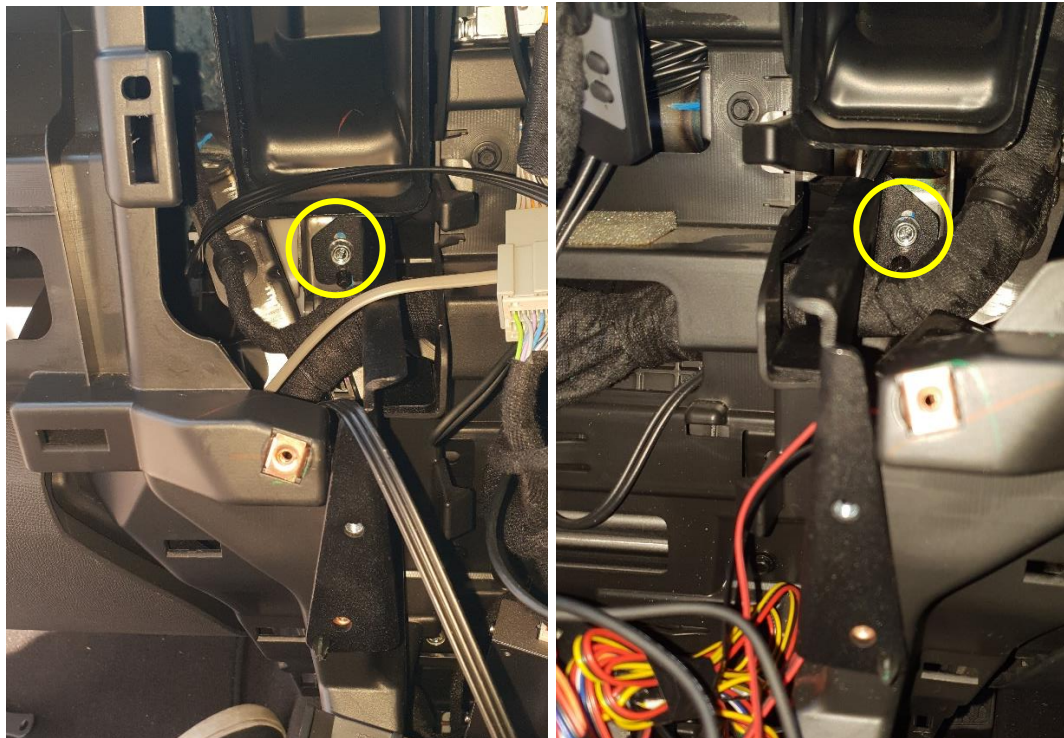

- 9 Reinstall lower control unit.



If you have any issues or questions, please contact us.

- 10** Reinstall lower panel around lower control unit, and right-side panel.

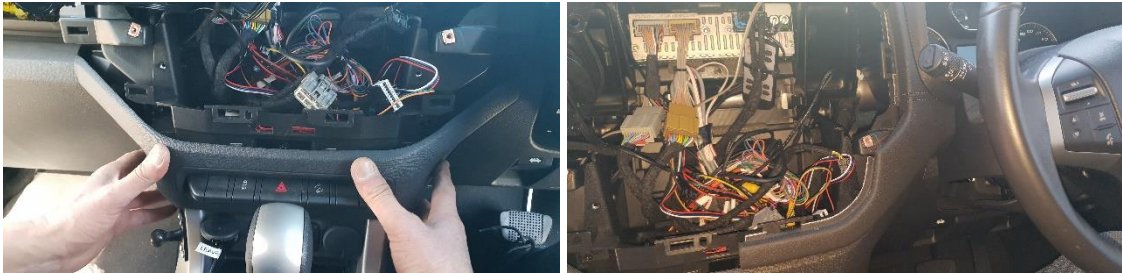

- 11** Reinstall passenger side panel and plastic trim.



- 12** Install brackets (L+R), using the 2x M5 pan screws provided.

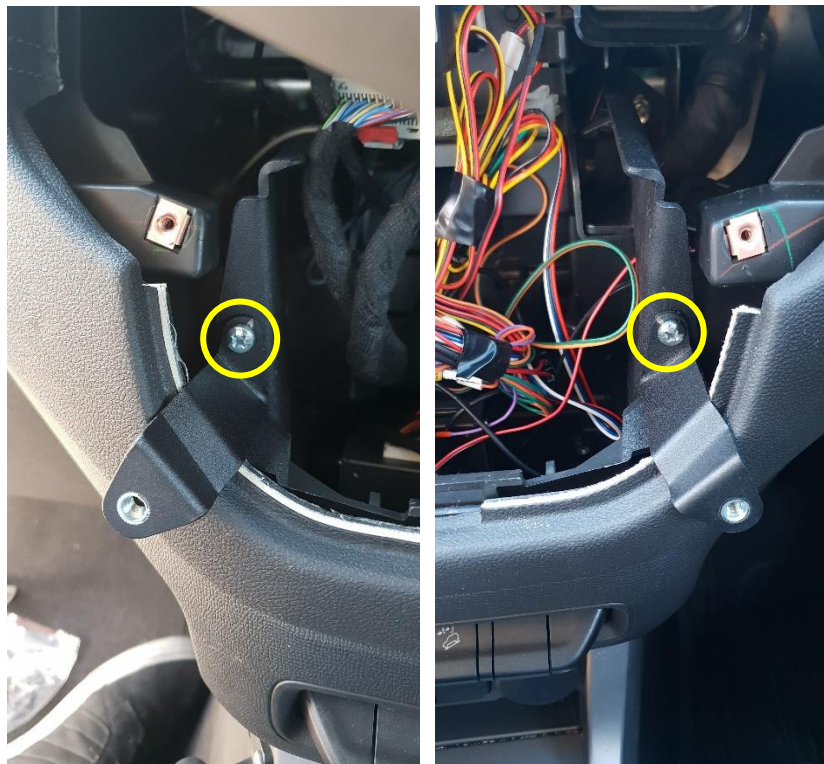

If you have any issues or questions, please contact us.

- 13** Carefully reposition central console, including all wires.  
Install brackets (L+R), using the existing screws.



- 14** Reinstall silver air vent trims.



- 13** Install dash bracket with 4x countersunk M5 screws provided.



Enjoy your new In Dash Mount!



If you have any issues or questions, please contact us.