

Installation Instructions Mazda BT50 (2020+)



STEP

INSTRUCTION

- 1** Lever and remove central display unit from dash as shown, removing rear cables.



- 2** Remove 2 x dash screws, then install first bracket in place.

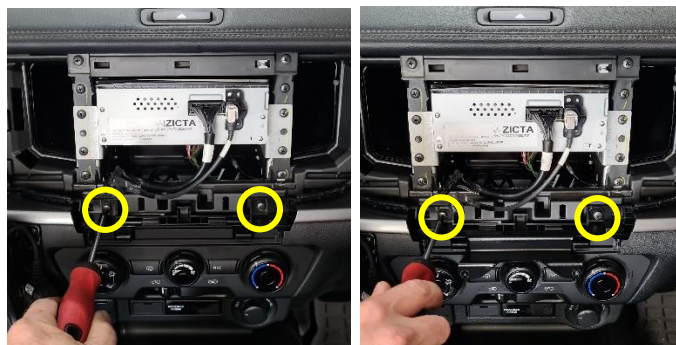

- 3** Remove 5 x screws and detach screen. Move second bracket into place.

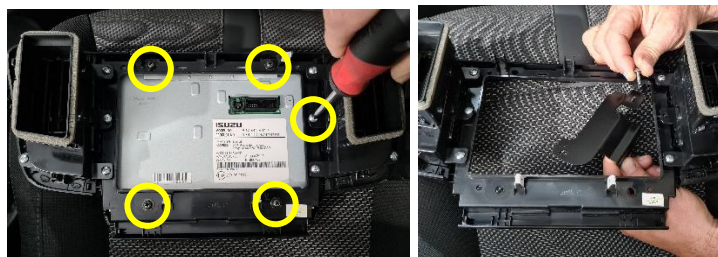

- 4 Fix bracket using 1 x screw, then reattach 4 x screws and screen.



- 5 Plug in and reinstall control unit and air vents.



- 6 Install front bracket using 4x countersunk screws provided.



Enjoy your new InDash Mount!

If you have any issues or questions, please contact us.
Industrial Evolution